



THE WORLD'S LEADING MANUFACTURER OF LABEL DISPENSERS,
REWINDERS, UNWINDERS, SLITTERS & COUNTING SOLUTIONS



UNIVERSAL LABEL SLITTER USER MANUAL

Safety first

AT LABELMATE, SAFETY IS OUR NUMBER ONE PRIORITY.
THE FOLLOWING INFORMATION PROVIDES GUIDELINES FOR
SAFETY WHEN USING LABELMATE EQUIPMENT.

Any piece of machinery can become dangerous to personnel when improperly operated or poorly maintained.

All employees operating and maintaining Labelmate equipment should be familiar with its operation and should be thoroughly trained and instructed on safety.

Most accidents are preventable through safety awareness.

Every effort has been made to engineer safety into the design of Labelmate equipment per standards set forth by ANSI and others that apply as necessary. Areas of potential danger are mechanically and/or electrically protected. Safety labels and instructional decals are visible to the operator and located near any potential hazard.

TRAINING AND INSTRUCTION

It is the responsibility of the customer to ensure that all personnel who will be expected to operate or maintain the equipment participate in training and instruction sessions and become trained operators. All personnel operating, inspecting, servicing or cleaning this equipment must be properly trained in operation and machine safety.

BEFORE operating this equipment, read the operating instructions in the manual.

GENERAL SAFETY

- Ensure that all power sources are turned off when the machine is not in use. This includes electrical power.
- Read the manual for any special operational instructions for each piece of equipment. The Labelmate product manual is included in the product packaging and can be found on the website www.labelmate.com
- Know how the equipment functions and understand the operating processes.
- Know how to shut down the equipment.
- Understand the equipment safety labels
- Wear the appropriate personal protective equipment for the job to be performed (EX: eye protection, gloves, safety shoes, etc.). Ensure that nothing you are wearing could get caught in the machinery.
- When working on or around all equipment, avoid wearing loose clothing, jewelry, unrestrained long hair, or any loose ties, belts, scarves or articles that may be caught in moving parts. Keep all extremities away from moving parts. Entanglement can cause death or severe injury.
- For new equipment, check plant voltage with the voltage specified on the machine. Electrical specifications for your machine are printed on the machine serial number tag. A properly grounded electrical receptacle is required for safe operation regardless of voltage requirements.
- Use the equipment only for its intended purpose.
- Keep the operating zone free of obstacles that could cause a person to trip or fall toward an operating machine. Keep fingers, hands or any part of the body out of the machine and away from moving parts when the machine is operating.
- Any machine with moving parts and/or electrical components can be potentially dangerous no matter how many safety features it contains. Stay alert and think clearly while operating or servicing the equipment. Be aware of operations and personnel in your surroundings. Be attentive to indicator lights and/or operator interface screens displayed on the machine and know how to respond.
- Do not operate machinery if you are fatigued, emotionally distressed or under the influence of drugs or alcohol.
- Know where the FIRST AID SAFETY STATION is located.
- Rotating and moving parts are dangerous. Keep clear of the operating area. Never put any foreign object into the operating area.
- Use proper lifting and transporting devices for heavy equipment. Some types of equipment can be extremely heavy. An appropriate lifting device should be used.

About your Slitter

Your Labelmate Slitter is a quick and easy way to produce much faster high quantities of smaller labels as you can print **multiple-across label rolls** and then slit them into separate, individual label rolls. The Universal Label Slitter is an “in-line” solution that can be placed at the output of any label printer when combined with a CAT-3-CHUCK rewinder.

LABEL SLITTERS

P/N	DESCRIPTION	MAX LABEL WIDTH (mm)
LMS010	Universal Label Slitter. Requires a CAT-3-CHUCK. Size: W x D x H: 300 x 157 x 170 mm.	250

GENERAL

- Weight: 6.9 KG
- Limited Warranty of 2 Years, extendable to 5 Years, 1 Year on the Power Supply

PACKAGE CONTENTS

Remove all parts from the shipping container and verify contents.

- User Manual (this document)
- Slitter Unit

Retain the shipping container and packaging for storage and transport.

IMPORTANT INFORMATION

- This product is a label slitter. It is only to slit rolls of labels in an indoor, dry environment.
- Use extreme caution when manipulating the blades.
- Do not adjust the blades while slitting.
- The machine is to be used on a flat surface, if the surface is not flat, it is to be fixed using the holes in the base plate
- The ambient light of the working area needs to be sufficient to avoid any risk.

USE CAUTION AND COMMON SENSE TO AVOID PERSONAL INJURY OR DAMAGE TO CLOTHING WHEN WORKING WITH CUTTING BLADES OR AROUND EXPOSED BLADE SURFACES

The English text is the original instruction. Other languages are translations of the original instructions.

Getting started

SET-UP AND USE

- 1. Place the Label Slitter so that it is perpendicular to the web of labels to be slit. Observe the Paper Path Label on the Slitter.
- 2. Being careful to avoid contact with the cutting blades, feed the label web under the Rotating Paper Guide
- 3. Adjust the position of Fixed Paper Guides to the width of your label web. Only finger tighten the screws.
- 4. Pull the label web through and affix it to the label rewind core on the Label Rewinder.
- 5. Being careful to avoid contact with the cutting Blades, adjust the position of the Blade Holders as desired. To do this, loosen the set screw of the Blade Holders and slide the Blade Holders in or out as needed. Finger tighten the set screw to hold the adjustment. Do not over tighten.
- 6. Start the Label Rewinder and the printer (if used). Adjust the speed of the Label Rewinder as required. See the CAT-3 User Manual for details.

When the slitting action becomes impaired because of dull Cutting Blades, the Blades can be replaced.

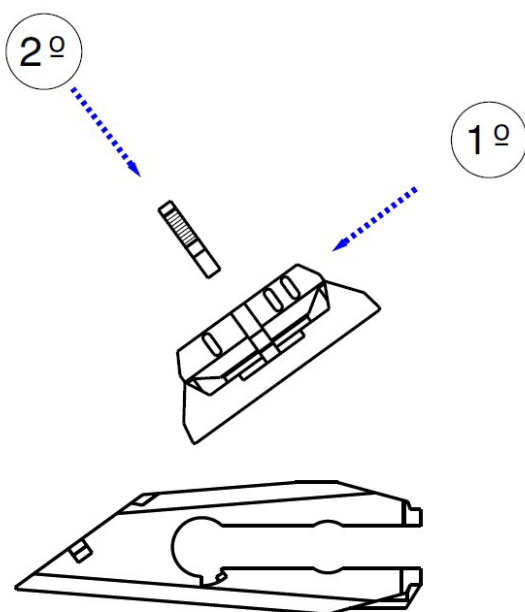
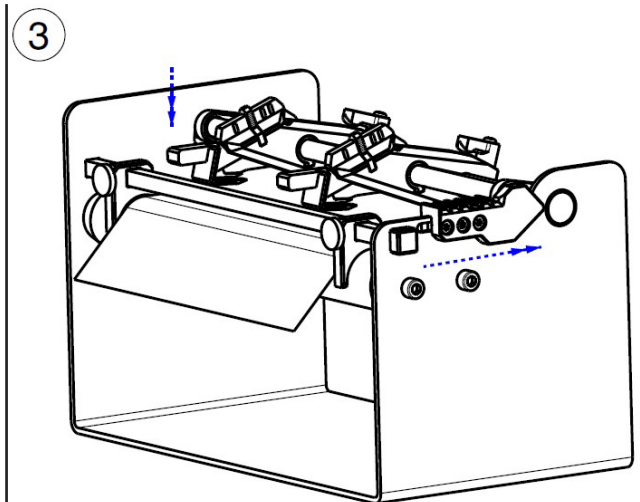
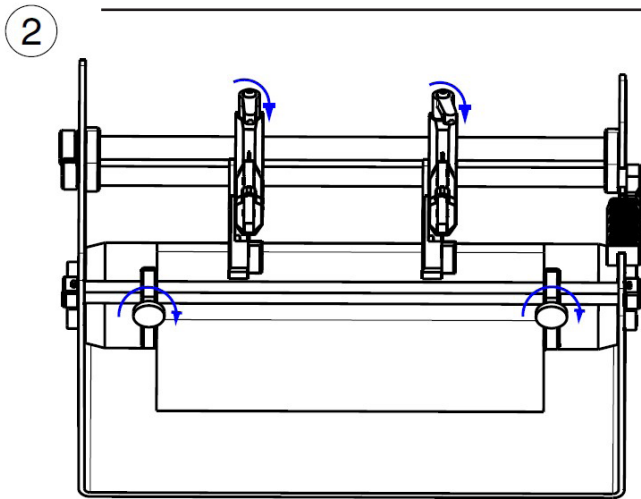
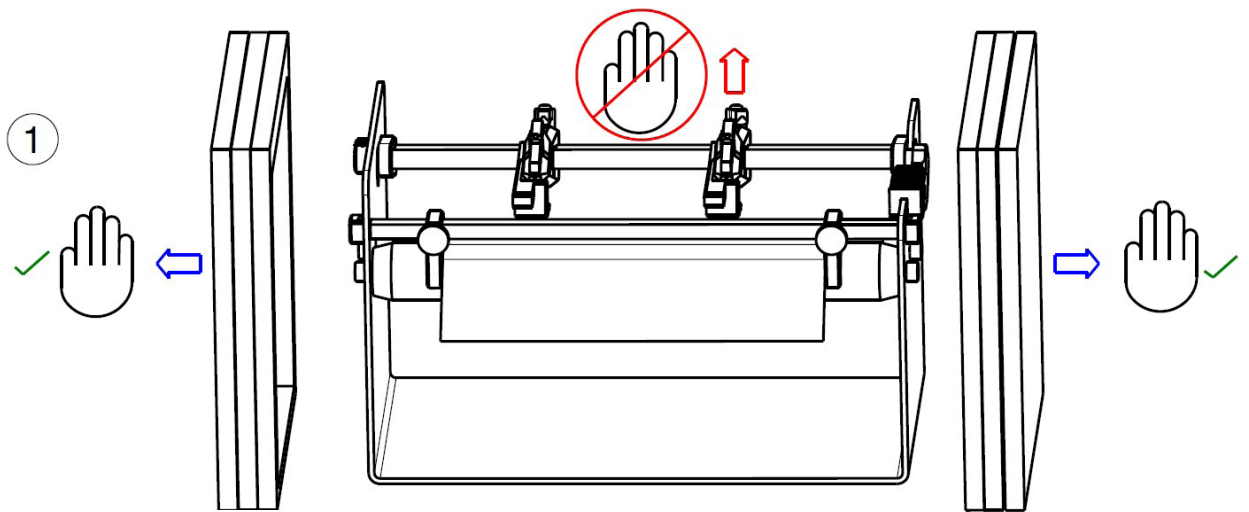



EC Declaration of Conformity for Machinery

Manufacturer: LABELMATE SRL-BV

Address: Bergensesteenweg 78, 1651 Lot – BELGIUM

Name and address of the person authorized to compile the technical file

Name: John Deckmyn

Address: Bergensesteenweg 78, 1651 Lot – BELGIUM

Herewith we declare under our sole responsibility that:

Product Description: Universal Label Slitter
Model: Universal Label Slitter
Part Numbers: LMS010
Serial Numbers: 22010200 to 29123199

- Are in conformity with the relevant provisions of the Machinery Directive (2006/42/EC)
 - Are in conformity with the provisions of the following other EC-Directives:
 - EMC: 2014/30/EU
 - RoHS: 2011/65/EU, as amended
 - Norms used:
 - EN ISO 12100: 2010
 - EN IEC 6300: 2018
 - EN 61000-6-3
 - EN 61000-6-1
- Technical Documentation: Internal Compliance process

Lot, 26/08/2022

John Deckmyn
Operations Director

1- product model/product

Product: Universal Label Slitter
Model Type: Universal Label Slitter
References: LMS010
Batch/Serial no.: 22010200 to 29123199

2- manufacturer

Name: Labelmate srl-bv
Address: Bergensesteenweg 78 - 1651 Lot - Belgium

3- this declaration is issued under the sole responsibility of the manufacturer**4- object of the declaration**

Specification: Label Slitters support to slit one roll into different individual label rolls

5- the object of the declaration described above is in conformity with the relevant UK statutory instruments (and their amendments)

2008 No. 1597 The Supply of Machinery (Safety) Regulations 2008
2016 No. 1091 The Electromagnetic Compatibility Regulations 2016
2012 No. 3032 The Restrictions of the Use of Certain Hazardous Substances in Electrical and Electronic Equipment Regulations 2012

6- references to the relevant designated standards used or references to the other technical specifications in relation to which conformity is declared

Norms used: EN ISO 12100 : 2010, EN IEC 6300:2018, EN 61000-6-3, EN 61000-6-1

Technical documentation: Internal compliance process.

7- the approved body : self-declaration applies**8- additional information**

The technical documentation for the machinery is available from:

Name: Labelmate srl-bv
Address: Bergensesteenweg 78 - 1651 Lot - Belgium
Signed for and on behalf of: Labelmate srl-bv
Place of issue: Lot Date of issue: 26/08/2022
Name: John Deckmyn Function: Operations Director
Signature:





+32 2 375 69 60

brussels@labelmate.com

Bergensesteenweg 78
1651 Lot (Belgium)

www.labelmate.com